

PREPARED FOR:
TOM MARTIN
KEEFE REAL ESTATE
1040 N. WISCONSIN ST.
ELKHORN, WI 53121

PATHFINDER SURVEYING, INC.
W2888 KRUEGER ROAD UNIT "D"
LAKE GENEVA, WI 53147
(262) 248-3697

PLAT OF SURVEY

- OF -

LOT 1 OF CERTIFIED SURVEY MAP No. 1387 ACCORDING TO THE
PLAT THEREOF RECORDED IN VOLUME 6, PAGE 244 OF CERTIFIED
SURVEY MAPS, DOCUMENT No. 107975, TOWN OF TROY, WALWORTH
COUNTY, WISCONSIN. EXCEPTING THEREFROM THAT PORTION OF LOT
1 CONVEYED BY DEED RECORDED IN VOLUME 335 OF RECORDS ON
PAGE 724 AS DOCUMENT No. 110054.

NOTE: ORIGINAL C.S.M. DOES NOT
MEET MINIMUM REQUIREMENTS
FOR CLOSURE OF 1' IN 3000' AS
DESIGNATED IN CHAPTER A-E 7.06(4)
OF WISCONSIN STATE STATUTES

NOTE: BASIS OF BEARING IS C.S.M. 1387.

COMPARE LEGAL DESCRIPTION ABOVE AND DRAWING WITH DEED. FOR BUILDING RESTRICTIONS AND
EASEMENTS NOT SHOWN, REFER TO DEED, ABSTRACT SOURCES AND LOCAL MUNICIPAL CODES. NOTIFY
THE SURVEYOR IMMEDIATELY OF ANY DISCREPANCY.

"I hereby certify that I have surveyed the above described property and that
the above map, to the best of my knowledge and belief, is a true representation
thereof and shows the size and location of all visible structures, apparent
easements and encroachments if any."

This survey is made for the present owners of the property, and those who
purchase, mortgage, or guarantee the title thereto, within one year from
the date hereof.

() = RECORDED AS

□ = FOUND IRON BAR

○ = FOUND IRON PIPE

■ = SET IRON BAR

● = SET IRON PIPE

SCALE: 1" = 50'

JOB #: 07-393

TAX ID #: LA138700001

(N 32°00'00" E 363.61')
(N 32°05'35" E 363.56')

(N 73°37'00" W 561.69')
(N 73°37'00" W 561.93')

(313.43')
(313.14')

78.50'

182.13'

FENCE CORNER
IS 1.8' SOUTH
AND 0.8' WEST
OF CORNER

FENCE CORNER
IS 0.3' NORTH OF
PIPE ONLINE

(S 52°21'00" E 378.50')
(S 52°20'20" E 378.20')
286.61'
(267.00')

WELL

EXISTING
RESIDENCE

WING WALL

CONC.

WING WALL

CONCRETE

ASPHALT DRIVE

GARAGE

RIGHT-OF-WAY
AS PER STATE
PROJECT No.
T 015-2(2),
ACCORDING TO
WALWORTH COUNTY
MAPPING RECORDS

RIGHT-OF-WAY
AS MONUMENTED

COUNTY TRUNK HIGHWAY "ES"
(WIDTH VARIES)

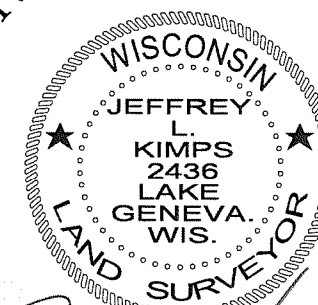
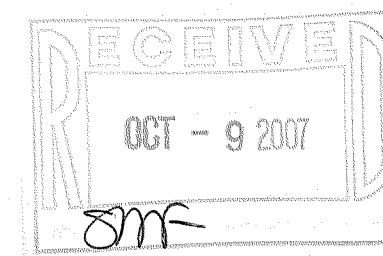

JEFFREY L. KIMPS S - 2436
Wisconsin Registered Land Surveyor
(original if signed in red)

DATED THIS 10th DAY OF SEPTEMBER, 2007.

417-850